

ASQUITH GIRLS HIGH SCHOOL



Cover artwork: Year 7 Visual Arts, Ava Arizabal, *Visual Elements Artwork*, 2022, Acrylic Painting |



2023
HANDBOOK



ASQUITH GIRLS HIGH SCHOOL
Established 1959

Stokes Avenue, Asquith NSW 2077

Telephone: (02) 9477 6411

Website: www.asquithgir-h.schools.nsw.edu.au

E-mail: asquithgir-h.school@det.nsw.edu.au

Office Hours: 8:15am – 3:00pm Mon – Fri during school term

School motto

'Learn to Live'

School colours

Russet and green

Mission Statement

To challenge our current mindsets and expectations through innovative whole-school practices that create a culture of aspirations, agility and agency within the global sphere.

TABLE OF CONTENTS

Principal's Welcome	2
School Term Dates	3
People You Should Know	4
Head Teachers	5
People Who Can Help You	6
Student Leadership Team	8
Student Leaders	9
Student Leadership Mission Statement	9
The Prefects	9
The Student Representative Council (SRC)	9
House Captains	9
Peer Support Leaders	9
Curriculum Organisation 2023	10
Faculty Information	12
English	12
Mathematics	12
Science	12
Human Society and Its Environment (HSIE)	12
Languages Other Than English (LOTE)	12
Technology & Applied Studies (TAS)	13
Creative & Performing Arts (CAPA)	13
Personal Development, Health & Physical Education (PDHPE)	13
Sport	14
Extra-Curricular Opportunities	16
School Band and Music Ensembles	16
Dance Ensembles	16
Drama Ensembles	16
Debating Teams	17

Mock Trial Competition	17
AIM (Asquith Individualised Mentoring)	18
AIM Coaching	18
The Role of the AIM Coach	18
XCEL Recognition of Achievement System	19
Sisters in Schools (SIS)	20
School Code of Behaviour	21
General Information	23
Attendance and Punctuality	23
Calendar	25
Canteen	25
Contact with students	25
Contact with school staff	25
Diary	25
Financial Contributions	25
School Contributions	25
Subject Contributions	25
Payment	25
Interviews	26
Learning Centre, Homework Hub & MEIOW	26
Learning Support	26
Library	26
Lockers	27
Medication	27
Money and personal property	27
Parents and Citizens' Association (P&C)	27
School website	27
Sentral Parent Portal	27
Sickness	27
Study at home	28
Supervision arrangements before school	28

Technology Guidelines	29
Bring Your Own Device (BYOD)	29
Acceptable usage of computing and communication devices	29
Access and security	29
Privacy and confidentiality	30
Intellectual property and copyright	30
Misuse and breaches of acceptable usage	30
Monitoring, evaluation and reporting requirements	30
Tips for technology use	30
Printing at school	31
Cybersafety	31
Transport	32
OPAL Card	32
2023 School Bus Timetable	32
Bell Times	33
School Map	34
School Uniform	35
The School Song	37

Principal's Welcome



Asquith Girls High School is an intellectually challenging environment that empowers girls to have a voice and become innovative thinkers, creative problem solvers and inspired learners prepared to strive in an ever changing world. Our focus is on the whole child, ensuring that each student has access to the very best learning opportunities to enable them to reach their full potential. Our diverse curriculum is driven by the needs of our students and is delivered by expert educators. Students are provided with extensive opportunities to participate in co-curricular activities such as: Leadership, STEM (Science, Technology, Engineering, Maths), recreational and elite sport, creative and performing arts, targeted literacy and numeracy, and outdoor education.

The academic results at Asquith Girls reflect our students' commitment to independent and collaborative learning in a safe and challenging working environment. We encourage dignity, enthusiasm and involvement through high expectations and co-operation, resulting in lifelong learning and personal growth. It is with pride that we encourage our students to commit to maintaining these high standards.

Pastoral care and wellbeing programs at Asquith Girls develop resilience, adaptability, knowledge and skills in our students to become autonomous, responsible and innovative builders of the future.

Our school has a strong bond with its community and encourages parental involvement in every step of our educational process. Collaborating with local schools and higher education institutions offers the opportunity to share ideas and engage in continuous educational improvement.

We welcome you to our vibrant learning community!

Learn To Live

A handwritten signature in black ink, which appears to read 'Elizabeth Amvrazis'.

Ms Elizabeth Amvrazis
Principal

School Term Dates

Term 1 2023	
Friday 27 January 2023	Staff Development Day (Staff only)
Monday 30 January 2023	Staff Development Day (Staff only)
Tuesday 31 January 2023	Years 7, 11 and 12 commence
Wednesday 1 February 2023	Years 8, 9 and 10 commence
Thursday 6 April 2023	Last day of term for all students
Term 1 Holidays: Friday 6 April to Sunday 23 April, 2023 inclusive	
Term 2 2023	
Monday 24 April 2023	Staff Development Day (staff only)
Wednesday 26 April 2023	All students commence
Friday 30 June 2023	Last day of term for all students
Term 2 Holidays: Saturday 1 July to Sunday 16 July 2023 inclusive	
Term 3 2023	
Monday 17 July 2023	Staff Development Day (staff only)
Tuesday 18 July 2023	All students commence
Friday 22 September 2023	Last day of term for all students
Term 3 Holidays: Saturday 23 September to Sunday 8 October, 2023 inclusive	
Term 4 2023	
Monday 9 October 2023	All students and staff commence
Friday 15 December 2023	Last day of term for all students
Monday 18 December 2023	Staff Development Day (staff only)
Tuesday 19 December 2023	Staff Development Day (staff only)

People You Should Know



Ms E Amvrazis
Principal



Ms M Abrahams
Deputy Principal (Rel.)
Stage 4 (Yr 7 & 8)



Ms M Farrugia
Deputy Principal
Stage 5 (Yr 9 & 10)



Ms C Key
Deputy Principal
Stage 6 (Yr 11 & 12)
Works: Mon, Fri

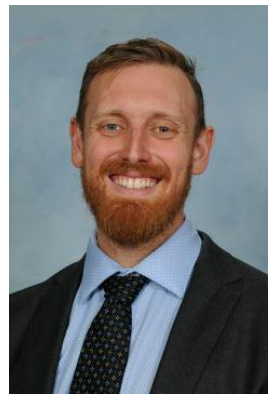

Mr J Wigan
Deputy Principal
Stage 6 (Yr 11 & 12)
Works: Tue, Wed, Thu

Ms E Eastman
Year 7 Year Adviser



Ms M Hallam
Year 8 Year Adviser

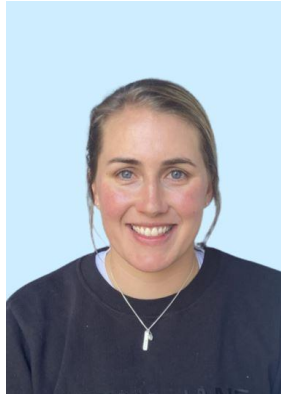

Mr N Pike
Year 9 Year Adviser



Ms M Ridley
Year 10 Year Adviser



Ms N Gardiner
Year 11 Year Adviser



Mr D Clarke
Year 12 Year Adviser



Head Teachers

POSITION	PERSONNEL
Head Teacher Wellbeing	Ms N Ravenscroft
Head Teacher Teaching & Learning	Ms J Dunn
Head Teacher Administration	Ms E Lee
Head Teacher Creative and Performing Arts (CAPA)	Mr J Edwards
Head Teacher English	Ms M Abrahams
Head Teacher Human Society & Its Environment (HSIE)	Ms C Key (Tue, Wed, Thu) Ms P Somerville (Mon, Fri)
Head Teacher Mathematics	Mr C Quinn
Head Teacher Personal Development, Health & Physical Education (PDHPE)	Ms M Clark
Head Teacher Science	Ms J Clay
Head Teacher Technology & Applied Science (TAS)	Ms M Barrett



"The Forgotten" by Ashlee H. Year 12 Visual Arts, nominated for Artexpress 2022

People Who Can Help You

Staff and students at Asquith are always willing to assist you. The guide below sets out some of the people who can provide assistance.

The Principal oversees the management, planning and vision for the direction of the school. They are the link between the Department of Education and the day to day management of the school. The Principal can be contacted on matters that need further resolution by making an appointment through the school office.

Deputy Principals oversee all aspects of the day to day running of the school. Any issues that have not been resolved through other staff will be referred to the Deputy Principal of that year group.

Year Advisers and Assistant Year Advisers assist students in each year group. They are responsible for looking after the interests of the students in their year. They should be the first point of call for any personal issues.

Head Teacher Wellbeing leads the Wellbeing Team at the school and implements programs to support the wellbeing of students and staff. They work closely with the Year Advisers, School Counsellors and School Executive. They liaise with external agencies/organisations to support and develop the understanding of current wellbeing issues.

Faculty Head Teachers lead teaching and learning of their key learning area and contribute to whole school programs to achieve the school's mission statement. For a subject specific problem, contact should be made with the Head Teacher of the particular faculty. Faculties are supported by the **Head Teacher Teaching & Learning** and the **Head Teacher School Priorities**.

Sports Coordinator will answer all your questions about curricular and extracurricular sport activities.

School Counsellors are experienced teachers and registered psychologists. They assist girls in general counselling, methods of study and in personal problems of a social or emotional nature.

Student Support Officer (SSO) works with students to improve their wellbeing and mental health. They work closely with the school counselling service and the school's wellbeing team.

Wellbeing and Health In-reach Nurse (WHIN) support students with their health and wellbeing needs. The WHIN also works with local health and social services to support students and their families on a wide range of health and wellbeing issues.

The Careers Adviser is a member of staff with experience in vocational guidance, who assists students in planning for their future career paths and is available by appointment.

English as Another Language/Dialect (EAL/D) Teachers are responsible for planning and teaching programs to meet the learning needs of students who have a language background other than English.

Learning and Support Teacher provides direct support for students with additional learning and support needs through a range of strategies.

Teachers are available for help with regard to any difficulty in a subject.

School Administration Staff play an essential role in keeping the business running smoothly and working to ensure all students are provided with the greatest possible opportunity to reach their full potential.

Information Technology Officer provides technical support in managing technology across the school.

"Call On Me" AGHS 2022 School Musical @ Concourse Theatre Chatswood



Asquith Girls High School

Developing high achieving young women who are responsible and independent leaders and learners.

Student Leadership Team

POSITION	PERSONNEL
School Captains	Harriet Kingham & Abigail Morgan
Vice Captains	Alyssa Flarey & Marley Kennedy-Jewell
Senior Prefect Environment	Ashleigh Herbert
Senior Prefect Creative & Performing Arts, XCEL & Assemblies	Mia Huntington
Senior Prefect Social Justice & Global Citizenship	Daria Suturina
Senior Prefect Wellbeing	Tayla Scott
Senior Prefect Sport	Abby Menzies-Jackson
Prefects	
Hanna Baracsi	Stephanie Barnes
Lucinda Cummings	Parisa Ghimire
Tanishka Luna	Gabriella Maguire
Jorja McHenry	Sammie McIntyre
Ellie Morgan	Neve Rapsey
House Captain Bates	Isabelle Cruickshank
House Vice Captain Bates	Liv Dryza
House Captain Chisholm	Rebecca Fowler
House Vice Captain Chisholm	Caitlan Foley
House Captain Gilmore	Ella Motum
House Vice Captain Gilmore	Emalee Price
House Captain Turner	Charli Wouters
House Vice Captain Turner	Alana Robertson
Student Representative Council (SRC)	
President	Rachel Daniel
Vice President	Kara Diment
Secretary	Callie Binet
Treasurer	Sofia Mann
Year 11 Representatives	Lena Baracsi, Stella Burns, Selloni Talifolau
Year 10 Representatives	Amelie Affarian, Keely Bourke, Esha Ghangas, Rachael Reed, Ashleigh Taylor, Maeve Townsend
Year 9 Representatives	Lottie Cheal, Megan Daniel, Gemma Mann, Annabelle Towler, Skye Triebel, Marissa Whiteman
Year 8 Representatives	Zoe Burnheim, Heidi Burr, Leanne Chong, Freya Crawford, Ciara Dabbene, Samantha Palozzi, Hayely Paterson, Angela Wheway

Student Leaders

Student Leadership Mission Statement

The fundamental aim of the student leadership team at Asquith Girls High School is to serve the student community. Every activity undertaken by either the Prefects, the Student Representative Council, House Captains, and Peer Support Leaders is underpinned by the belief that every single student is valuable and has unique talents and gifts. All groups strive to further develop a school climate that enables students to voice their opinions, participate in decision-making and make a meaningful contribution to the school community. Essentially, student leaders work for the benefit and empowerment of the students they represent.

The Prefects

Prefects are elected by Year 11 students and staff. They lead the leadership team, which is comprised of themselves, the SRC, Sports Captains and Peer Support leaders. Each prefect has a specific portfolio for which they are responsible.

The Student Representative Council (SRC)

The SRC is elected by students in Years 7-11. Each year group selects their own members, who represent the interests of that year group.

House Captains

Sport House Captains are elected by each House. They promote the benefits of sporting activities within and outside the school.

Peer Support Leaders

The Peer Support Leaders are chosen from Year 10 to work with Year 7 students to assist in a smooth transition to high school. Peer Support Leaders continue to work with Year 7 students throughout the year and often develop firm friendships that continue throughout high school.



Curriculum Organisation 2023

Stage 4 (Years 7 & 8) all students will study:

English	Language - French or Japanese (Yr 7)
Dance (Yr 7)	Visual Arts
Drama (Yr 7)	Music
Mathematics	PDHPE
Science	Sport
History	Literacy
Geography	Numeracy
Mandatory Technology (Food, Textiles, Timber, Plastics)	Connecting Learning & Life (Yr 7)

In Year 8, students will also have the opportunity to study one elective course each semester. Details about elective course options will be provided in Term 2 2023.

Stage 5 (Years 9 & 10):

MANDATORY

English
Mathematics
Science
Australian History, Civics & Citizenship
Australian Geography, Civics & Citizenship
PDHPE
Sport
Careers (Yr 10 only)

ELECTIVES

Authentic Learning (Yr 9 only)
Big History
Child Studies
Commerce
Dance
Design & Technology
Drama
Food Technology
French
STEM
Industrial Tech
Multimedia
International Studies
Japanese
Marine and Aquaculture Technology
Music
Photographic & Digital Media
Physical Activity and Sport Studies
Psychology
Textiles
Visual Arts

Note:

- ICT (Information and Communication Technology) skills are integrated into all courses.
- Special Religious Education (SRE) is available to students in Years 7 – 10. At Asquith Girls High School options include combined Christian SRE provided by Hornsby and Asquith Districts Christian Education Association (HADCEA), or Islamic SRE provided by Islamic Council of NSW.

Stage 6 (Years 11 & 12):

Both the Preliminary and HSC course patterns must include English, at least six units of Board Developed Courses, at least three courses of two units value (or greater) and at least four subjects.

Students in Year 11 (Preliminary) must study 12 units of subjects. Students in Year 12 (HSC) must study at least ten units of subjects.

Courses offered in the senior school may vary according to students' choice:

Ancient History	Mathematics Standard 1
Biology	Mathematics Standard 2
Business Studies	Mathematics Advanced
Chemistry	Mathematics - Extension 1 & Extension 2
Community and Family Studies (CAFS)	Marine Studies *
Dance	Modern History
Design & Technology	Music 1
Drama	Music 2
Earth & Environmental Science	Music Extension
Economics	Personal Development, Health & Physical Ed
English Standard	Photography, Video & Digital Imaging *
English Advanced	Physics
English - Extension 1 & Extension 2	Science Extension
English as an Additional Language / Dialect	Society & Culture
English Studies	Software Design & Development
Exploring Early Childhood *	Sport, Lifestyle & Recreation (SLR)
Food Technology	Studies of Religion
French – Beginners & Continuers	Textiles & Design
Geography	Visual Arts
History Extension	VET Business Services (Cert II in Business)
Industrial Technology Multimedia	VET Hospitality (Cert II in Kitchen Operations)
Information Processes & Technology	VET Retail (Cert II in Retail)
Investigating Science	
Japanese – Beginners & Continuers	
Legal Studies	

* Content Endorsed Courses – these courses do not contribute to an ATAR

Faculty Information

English

English is a compulsory subject for all students from Year 7-12. Whilst still delivering all the traditional aspects of reading and writing, the English faculty also offer challenging opportunities in the use of future-focussed learning skills, including the use of technology. Excellent resources allow us to integrate computers and film making into day-to-day lessons, as well as provide time for junior classes to focus on reading a wide range of text types. Teaching programs and assessment tasks are differentiated in order to help every student achieve their best in this essential learning area. A variety of assessment strategies are also being used to ensure all students meet success in English across the stages.

Mathematics

Students study a common course in Years 7 & 8 Mathematics, with extension topics taught where appropriate. The Year 9 & 10 Mathematics course is offered at three different levels in preparation for the senior school. The school offers the HSC Mathematics curriculum at all levels in Year 11 & 12, including Mathematics Extension 1 & 2. All students participate in theoretical and practical activities both inside and outside the classroom, and integrate technology into their learning through the use of online learning platforms.

Science

Science is a compulsory subject for Year 7 – 10 students. In Science, students experience a wide variety of scientific experiments, field trips and excursions, and use a number of online learning platforms. In Year 9 & 10, students are also able to study Marine Studies as an elective subject in addition to their compulsory Science course. The Science staff have expertise and qualifications across all aspects of the curriculum, enabling the school to offer every Science course up to HSC level. In Year 11 & 12, students at Asquith can choose from Biology, Chemistry, Physics, Earth and Environmental Science, and Investigating Science.

Human Society and Its Environment (HSIE)

Human Society and Its Environment (HSIE) includes a number of compulsory and elective subjects. In Year 7-10, all students complete both History and Geography, which are studied for one semester each. In History and Geography, students are involved in fieldwork, site studies, practical lessons, and gathering, processing and analysing information in new and exciting ways. In Year 9 & 10, students also have the option to choose a number of HSIE electives, including International Studies, Business Services and Commerce. In Year 11 & 12, HSIE subjects that are available to study include Ancient History, Modern History, Geography, Business Studies, Economics, Legal Studies, Studies of Religion, and Society and Culture.

Languages Other Than English (LOTE)

Languages Other Than English (LOTE) is a compulsory subject in Stage 4. Students can choose whether they learn French or Japanese in Year 7. In junior school, part of the fun is learning about other places and cultures, especially trying some different and delicious food! Our staff are highly qualified language specialists, which means students can choose to continue to study these languages as elective subjects in Year 9, 10, 11 and 12.

Technology & Applied Studies (TAS)

Mandatory Technology is a compulsory course for all students in Years 7 & 8. This subject gives students the opportunity to experience a small sample of all aspects of the Technology and Applied Studies key learning area, including Information and Digital Technology, Engineering and Timber Materials Technology in Year 7; Food Technology, Textiles and Agriculture in Year 8.

In Year 9 & 10, students will have the option to choose all of these areas of learning as individual subjects as part of the electives that the school offers. These subjects can also be studied in Year 11 & 12, along with Software Design and Development, Industrial Technology Graphics, and Hospitality, which is a Vocational Education and Training (VET) course.

The resources and facilities used by the students include two fully functional commercial kitchens, two timber workshops, a future-focussed learning space designed to enhance collaborative learning, and well-resourced Textiles rooms, with state of the art computerised sewing machines, overlockers and commercial ironing presses. Students have access to desktop computers, laptop computers, graphics tablets and 3D printers.

Creative & Performing Arts (CAPA)

Visual Arts: All students study Visual Arts in Year 7 & 8, where they experience a variety of creative media. This may include painting, ceramics, printmaking, drawing, digital photography and sculpture. In Years 9-12, students can continue to develop their creative skills in Visual Arts as an elective subject. Additional elective subjects include Photography and Visual Design.

Music: Students learn about a range of areas in Music, which is compulsory in Year 7 & 8 and an elective subject in Years 9-12. Areas of study include performance (using guitars and keyboards in Year 7 & 8), ensemble work, composition, musicology and listening. Students can further express their passion for music through participation in one of the school bands or vocal ensembles.

Drama: This is an elective subject from Years 9–12. Students in Year 7 are given the opportunity to study Drama for one semester. Students with an interest in Drama are also encouraged to join one of the extra-curricular drama groups or audition for the school musical.

Dance: Dance is another elective subject from Years 9–12, which is also studied in Year 7 for one semester. Students can also audition to be a part of extra-curricular dance companies and ensembles that perform in regional festivals and school productions/events.

Personal Development, Health & Physical Education (PDHPE)

In Years 7-10, Personal Development, Health and Physical Education (PDHPE) is a compulsory subject. Students develop skills and knowledge that will enable them to live healthy and satisfying lives, both now and into the future. Students also participate in a range of physical activities in this subject to assist them in developing lifelong physical activity habits.

In Year 9 & 10, students can choose to study Physical Activity and Sports Studies (PASS) as an elective subject. In Year 11 & 12, subjects offered include PDHPE, Community and Family Studies (CAFS), and Sport, Lifestyle and Recreation (SLR).

Sport

Integrated Sport: Year 7 students have Sport integrated into their curriculum. Integrated Sport lessons are taught by specialist PDHPE teachers at various times throughout the week. During this time, students participate in a range of different sports, and learn the skills, rules and tactics associated with them.

Monday Afternoon Sport: Students in Years 8-10 participate in a weekly Sport program for two hours every Monday afternoon. Students have the opportunity to represent the school in grade sport competitions against other girls' schools from across the northern Sydney area, or they can participate in a number of recreational sport options at school or at locations around Asquith and Hornsby. Some recreational sports have a cost involved, which students must pay after selecting these sports.

Carnivals: The annual Swimming, Cross Country and Athletics carnivals are big events on the school calendar. There is a strong tradition of excellence and inclusiveness in these whole school events, where opportunities to participate exist for students of all abilities. These carnivals form the first step in qualification for students to represent the school at higher levels in these sports.

Every student is placed in a House for these carnivals. The Houses are named after famous women.

BATES (Yellow)	CHISHOLM (Blue)	GILMORE (Red)	TURNER (Green)
-----------------------	------------------------	----------------------	-----------------------

Representative Sport: At Asquith Girls, we have a proud culture of participation and success in representative sport competitions. The school has teams that compete in a wide variety of sports, including Basketball, Netball, Softball, Football (Soccer), Water Polo, Touch Football and Volleyball. A number of these teams have been extremely successful, with particular highlights recently for our Basketball team who were the 2019 NSW Combined High Schools Champions.

Students also have the opportunity to represent the school at region, state and national levels in individual sports such as Athletics, Cross Country, Swimming, Triathlon, Sailing and Gymnastics.

Students with a passion and aptitude for Sport are encouraged to get involved in the Representative Sport program at Asquith Girls.

Asquith Girls High School competes as part of the North West Metropolitan Girls Zone under the umbrella of the Sydney North Schools Sports Association (SSA) and the NSW Combined High Schools (CHS) Sports Association.

The North West Metropolitan Girls Zone involves Asquith Girls, as well as Hornsby Girls High School, Macarthur Girls High School, Riverside Girls High School, Cheltenham Girls High School and North Sydney Girls High School.

We compete with these schools at the Zone level Swimming, Cross Country and Athletics carnivals. Students who successfully progress on from the Zone carnival (typically reserved for the top two place-getters) will secure a position at the corresponding Sydney North SSA event.

Our representative teams participate in the Sydney North SSA knockout competition, with the opportunity to progress to the NSW CHS competition if we are successful. For some sports, there are both Under 15's competitions and an Opens competition, however, some will only have an Opens draw. This means that students from any year or age group are able to trial for a place on the team and participate if they are selected. Please note that it is less likely that younger students will be selected in an Opens team unless they are very strong in that sport as they will be competing against much older students for a position in the team.

Selection in Representative Teams: The trial process for school based knockout teams at Asquith Girls High School involves several key steps:

- Students will be notified in advance of upcoming trials via the Daily Notice system at school. These notices can also be accessed via the Sentral Parent and Student Portal.
- A minimum of two trials will be conducted for each sport. In some cases, more trials may be necessary in order to select a team.
- Trials will be overseen by at least two members of staff. Typically, this will involve the Coach of the team and the Sport Coordinator, however, other members of staff with experience, interest or expertise may be involved in the selection process.
- Once a team has been selected, the successful team list will be posted on the Sports Noticeboard outside the PDHPE Staffroom.

In 2022, Asquith Girls High School had teams entered in:

- Open and Under 15's Water Polo
- Open and Under 15's Netball
- Open and Under 15's Basketball
- Open Tennis
- Open Touch Football
- Open Volleyball
- Open Softball
- Open Football (Soccer)

The school frequently enters teams into competitions and gala days run by other sport associations and organisations, such as the Bill Turner Trophy for U15 Football (Soccer) and the Football NSW Futsal competition. Students will be informed of these additional opportunities through the Daily Notices.

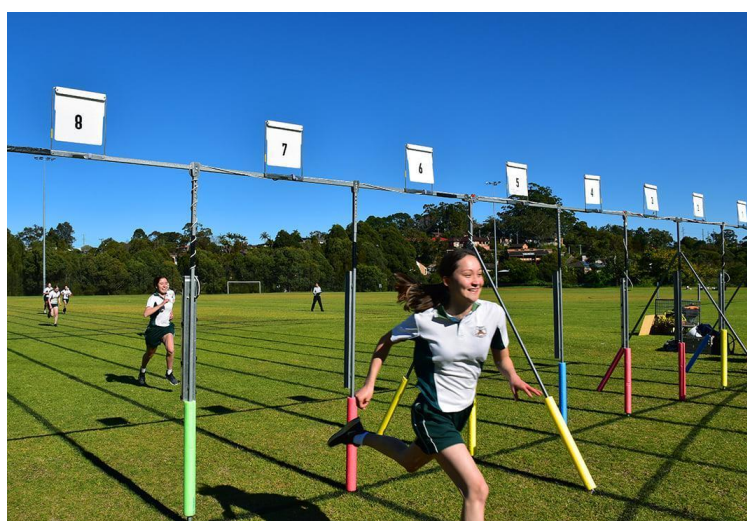

Extra-Curricular Opportunities

There are a variety of different activities which students can be involved in at Asquith Girls HS. Students are encouraged to seek out these opportunities based on their strengths and interests. Options include:

- Anime/Manga Club
- Photography Club
- Band and Music Ensembles
- Dance ensembles
- Drama ensembles
- Representative Sport
- Social Justice Team
- Environment Team
- Language Club
- Art Club
- STEM Club
- Mock Trial
- Debating
- Public Speaking Competitions
- Writing Competitions

The availability and frequency of many of these clubs will depend on the level of student interest. Some of these extra-curricular opportunities are outlined in more detail below. Please contact the school for more information.

School Band and Music Ensembles

The school has a range of different bands and music ensembles, some of which combine with Asquith Boys High School. These groups consist of enthusiastic performers of diverse skills and ability who meet before school to practise. All bands and music ensembles will participate in a variety of activities and performances each year both within and outside of school. New members are welcome as we continue to play to the tune of musical excellence.

Dance Ensembles

The school has a number of Dance ensembles for students of different ages. The Year 7 Dance Ensemble is a great introduction to dance at Asquith Girls High School, giving students the opportunity to progress their technique and performance quality in lyrical and contemporary forms. The Year 8 Dance Company offers students in Year 8 the opportunity to progress their dance technique during Monday afternoon sport time. There are also a number of companies available for students from Years 8 - 11 to audition, including Company Pink and Company Blue. These companies give students the opportunity to develop their performance quality as well as composition skills to choreograph with their teacher to create contemporary dance works.

Drama Ensembles

Students with a passion for Drama can join one of the many Drama ensembles. The Year 7 Drama Club meets at lunch on Monday for any students who are interested in exploring their interest in Drama. The Junior and Senior Drama Ensembles require students to audition and rehearse after school. Asquith Girls also enters Junior, Intermediate and Senior Theatresports teams into local competitions.

Debating Teams

Asquith Girls High School competes in the Premier's Debating Challenge. We enter teams into each division: Junior (Year 7 & 8), Intermediate (Year 9 & 10) and Senior (Year 11 & 12) competitions. Debating is an enriching activity encouraging students to think logically and empathetically to construct arguments on an array of social issues, fostering skills required for confident leaders of the future.

Mock Trial Competition

The Mock Trial Competition involves a team of six Year 11 Legal Studies students playing the roles of barristers, lawyers and witnesses in a mock courtroom trial. It is run by the Law Society of NSW and is a practical means of introducing students to the law and to increase understanding of the basis of our judicial system. A team may act as either the defence or prosecution during a trial, with each team member taking on the role of a barrister, solicitor, court officer or witness, pitting their skills against the opposing side - a team from another school.



AIM (Asquith Individualised Mentoring)

AIM Coaching

The AIM Coaching program is an Asquith Girls High School initiative designed to provide students with voice, choice and influence in their learning. This structured and collaborative coach/student relationship empowers students to:

- actively engage with their learning
- navigate and address learning challenges
- develop decision-making, negotiation, goal setting and communication skills.

All students from Year 7-12 take part in this program. Each cohort has a specifically designed program to support their learning journey. They will engage with the mindset continuum, understand their learning type and helpful intrinsic nudges to set goals and keep moving forward in their learning. Furthermore, they will develop a knowledge of important habits of mind and how to optimize their learning zone.

The AIM Coaching program forms an important initiative in the school's Strategic Improvement Plan for 2022-2025, and is designed to ensure that every student is known, valued and cared-for. It ties closely with our mission statement: *To challenge our current mindsets and expectations through innovative whole-school practices that create a culture of aspirations, agility and agency within the global sphere.*

The Role of the AIM Coach

All teaching staff at Asquith Girls High School take responsibility for coaching a group of students. AIM coaches run three group sessions per school term. The group sessions are approximately 40 minutes and are timetabled into the school calendar on Tuesdays during the allocated assembly time (9:40-10:22am). AIM groups consist of 12- 15 students. In addition to these timetabled AIM group sessions, coaches will meet with each student individually once per term for 15 minute personalised coaching sessions which focus on the individual student's learning goals.

AIM Coaches utilise the LACE coaching approach and the language of Habits of Mind to coach and guide students as they work towards developing the skills, dispositions and knowledge needed to achieve their learning goals. LACE is an acronym outlining the following coaching process:

- Listen
- Ask questions that prompt student thinking
- Challenge student perception and perceived realities to inspire them to achieve more
- Establish the next steps

The school collaborates with internationally renowned academic James Anderson in the implementation of this program. Teachers have completed professional learning in Growth Mindsets, Habits of Mind and effective coaching conversations to enhance the effectiveness of the AIM Coaching sessions.

XCEL Recognition of Achievement System

The **Asquith XCEL Recognition of Achievement System** acknowledges effort and achievement in all aspects of school life.

XCEL points are awarded based on our four key values:

X	eXcellence <ul style="list-style-type: none">• Unit of Work or Test Result = 1 point• One Semester = 3 points• Whole year achievement = 5 points
C	Commitment <ul style="list-style-type: none">• Community Contribution = 1 point• Co-curricular = 1 point
E	Effort <ul style="list-style-type: none">• Participation = 1 point• Outstanding Contribution = 2 points• Sustained Application = 3 points
L	Leadership <ul style="list-style-type: none">• Initiative & Engagement – School Service = 1 point

XCEL points are tallied each semester.

The top 10 students in each year group will be acknowledged at the end of each semester by being awarded an XCEL badge. This badge will be presented at the **XCEL Recognition of Achievement Assembly**.

Each student will have the opportunity to celebrate their achievement by inviting two guests to attend the **Principal's Morning Tea** after the assembly.

Students who earn an XCEL badge for each of their years at school are awarded an **Asquith Gold** when they graduate from Year 12.

The student who has gained the highest total by the end of Year 12 is awarded the **Asquith Shield** in recognition of their consistent achievements across the years.

Sisters in Schools (SIS)

The Sisters in School program enables students to explore social and emotional learning, developing skills to support their wellbeing through vertically integrated student groups. The SIS program is structured so that students from across Years 7-9 are placed in small groups to work collaboratively together to explore wellbeing issues that are relevant to them in an age-appropriate manner. Similarly, students from across Years 10 to 12 are placed together in small groups to address wellbeing issues that are pertinent to their age and development.

SIS sessions are held once each term. Sessions are led by SIS Leaders from Years 8 to 11 who have volunteered to train, contribute to and deliver these wellbeing sessions with the support of a teacher. Sessions are centered on the [Department of Education wellbeing framework](#) and the [PERMA Positive Psychology](#) framework. The learning activities are designed for students to work together, forming connections and sharing values-based learning experiences across cohorts.



School Code of Behaviour

At Asquith Girls High School, our wellbeing structure is based on positive psychology and utilises the Positive Behaviour for Learning framework. All students are encouraged to follow the school XCEL values. Students are expected to behave in a manner demonstrating:

- respect for themselves and others
- responsibility for their own learning
- responsibility for their own actions
- acceptance of individual differences
- respect for the property of others
- the promotion of a safe and caring school environment for all
- a positive attitude toward achieving their full potential
- pride for the whole school
- courtesy and co-operation towards staff and fellow students
- pride in wearing the school uniform and personal appearance
- compliance with school policy
- compliance with zero tolerance to bullying and use of illegal substances.

											
X		Share all spaces safely	Follow teacher instruction	Respect the facilities and keep it clean	Participate in positive break time activities	Follow instructions and school procedures	Show pride in your own and others' school achievements	Represent AGHS with pride	Leave the room as you found it	THINK before you post	Show pride for AGHS in all you do and say
C		Be cautious of your turtle shell Keep to the left Line up quietly	Use your designated line	Be respectful when getting changed Be mindful of personal space, health & safety	Be respectful to everyone Follow staff instructions	Be courteous and polite towards others Honour AGHS traditions	Enter and exit hall by following teacher directions Show courtesy to community members	Use good manners and appropriate language	Leave the door open Ensure the room is ready for the next lesson	Respect everyone's right to privacy Post positive	Use polite & respectful language Care for your environment
E		Seek permission if out of class Move quickly and quietly	Wait in line patiently and calmly Wait behind the line	Use hygienic practices	Rubbish goes in the bin Remain in-bounds Move promptly to class	Be organised with notes and payments Follow procedures when signing in or out	Phones out of sight Show respect by sitting quietly and listening attentively	Follow all rules and make safe choices when travelling	Put your rubbish in the bin Remain in allocated rooms	Be aware of your digital footprint Reference information appropriately Use technology for learning	Wear the uniform with pride and respect Use technology for learning when in class
L		Be polite when passing people Help others who need help	Report concerns to a teacher Be a positive role model	Report concerns to a teacher	Include others Report a stranger to the teacher	Ask for help when needed Assist others	Show appreciation with dignity	Give up your seats for those in need Report unsafe or inappropriate behaviour to authorities	Encourage peers to do the right thing Report inappropriate behaviour or damage to a teacher	Report offensive posts Seek permission prior to taking or uploading content	Do your best & encourage others

AGHS Behaviour Matrix

The following is the NSW Department of Education's Behaviour Code for Students:

NSW public schools are committed to providing safe, supportive and responsive learning environments for everyone. We teach and model the behaviours we value in our students.

In NSW public schools, students are expected to:

- Respect other students, their teachers and school staff and community members
- Follow school and class rules and follow the directions of their teachers
- Strive for the highest standards in learning
- Respect all members of the school community and show courtesy to all students, teachers and community members
- Resolve conflict respectfully, calmly and fairly
- Comply with the school's uniform policy or dress code
- Attend school every day (unless legally excused)
- Respect all property
- Not be violent or bring weapons, illegal drugs, alcohol or tobacco into our schools
- Not bully, harass, intimidate or discriminate against anyone in our schools

Schools take strong action in response to behaviour that is detrimental to self or others or to the achievement of high quality teaching and learning.

Behaviour Code for Students: Actions

Promoting the learning, wellbeing and safety of all students in NSW Public Schools is a high priority for the Department of Education. We implement teaching and learning approaches to support the development of skills needed by students to meet our high standards for respectful, safe and engaged behaviour.

Respect

- Treat one another with dignity
- Speak and behave courteously
- Cooperate with others
- Develop positive and respectful relationships and think about the effect on relationships before acting
- Value the interests, ability and culture of others
- Dress appropriately by complying with the school uniform or dress code
- Take care with property

Safety

- Model and follow departmental, school and/or class codes of behaviour and conduct
- Negotiate and resolve conflict with empathy
- Take personal responsibility for behaviour and actions
- Care for self and others
- Avoid dangerous behaviour and encourage others to avoid dangerous behaviour

Engagement

- Attend school every day (unless legally excused)
- Arrive at school and class on time
- Be prepared for every lesson
- Actively participate in learning
- Aspire and strive to achieve the highest standards of learning

General Information

Attendance and Punctuality

Daily school attendance

All students who are enrolled at school, regardless of their age, are expected to attend school whenever instruction is provided. Regular attendance at school is essential to assist students to maximise their potential, enhance their learning and increase their opportunities, both during the school years and once they leave school.

The school day officially starts at 8:40am with a bell to signal the start of Period 1. A warning bell will ring at 8:35am to signal for students to move to class. All students are required to attend all lessons scheduled on their timetable.

Absence

Parents/caregivers are required to explain their child's absence, including lateness, within seven days. This can be done by replying directly to the absence notification SMS sent by the school, by sending an email to the school, using the Parent Portal or sending a written explanation to the school to hand in at the Administration Office on the first day of the student's return.

Please be aware that explanations will need to be in writing using one of the methods listed above, as verbal explanation provided over the phone is not considered a sufficient means of providing an explanation by the Department of Education.

Late arrival to school

A student who arrives after 8:40am is required to go directly to the Administration Office to sign in to school. Late students are required to present a written explanation from a parent or caregiver, unless an exceptional circumstance has occurred on the way to school.

Students must go to the Administration Office and swipe their school ID card to sign in. Students will receive a printed slip after swiping their card, which must be shown to their classroom teacher on arrival to class. If no written explanation from a parent/caregiver has been received by the school for the lateness, students must also take the printed slip home for a parent/caregiver to sign and then return it to the Administration Office on the next school day.

Notifying parents/caregivers of absence or lateness to school

When a student is absent or late to school, an SMS message will be sent to the mobile phone number of the parent or caregiver listed as the primary contact on the student's records.

Parents/caregivers are requested to respond to the SMS message in text format only stating the reason for this absence. Please do not send pictures as they cannot be identified by the attendance system.

At the start of each week, a reminder email will be sent to the email address of the parent or caregiver listed as the primary contact for any absences from the previous week that have not yet been explained. Any absence for which the school does not receive explanation within 7 days will be recorded as unjustified.

Early leave

Any student who wishes to get approval for early leave must have written permission from a parent/caregiver stating the date, student's name, year group, reason for early leave and time of departure, and be signed by the parent/caregiver.

Students must:

1. Take the note to a Deputy Principal for approval before 8.30am then present the approved note to the Administration Office for processing
2. Collect their Early Leavers pass prior to leaving the school grounds

Please note: Early leave passes should be arranged before 8.30am. Parents/caregivers are asked not to present at reception requesting to withdraw their child without having provided written permission at the start of the school day, except in the case of genuine emergencies.

Students who become unwell at school

When a student becomes unwell during the school day, they must report to the sick bay and notify a member of the administration staff. Students should not contact parents directly as the school has a duty of care for the student and need to be informed of any health issues so that they can be managed appropriately.

If students are unable to continue with their normal lessons, the school will notify a parent or caregiver and request that they collect the student. In circumstances when the school is unable to contact a parent or caregiver, the emergency contacts listed on the student's file may be called.

Students who are unwell and are under the age of 18 must be collected by a parent, unless written notification is received by the school stating that the parent or caregiver takes responsibility for the student travelling home alone. Only in extraordinary circumstances will students under the age of 16 be given approval to travel home alone. The school will not allow students to travel home alone in any circumstances if they are not well enough to do so.

Application for extended leave - travel

Students are expected to attend school whenever instruction is provided. When it is anticipated that students will be absent from school for planned travel of longer than five days, an Application for Extended Leave needs to be completed and submitted to the school for review by the Principal. Parents must ensure that travel documentation, such as travel itinerary or e-ticket, is attached to the application. It is recommended that this application is completed and returned to the school as far in advance of the planned travel as possible.

The Principal will not approve travel during school term if it is deemed that the travel does not meet the requirements of the Department of Education policies and procedures. Where the Principal has declined an Application for Extended Leave – Travel, the parent or caregiver will be advised in writing.

Please be aware that family holidays are not considered as an acceptable reason for leave under the Department of Education Exemption from School Procedures. Travel for family holidays outside of vacation periods is now counted as an unjustified absence and will be shown as such on school records. Therefore, parents and caregivers are encouraged to take holidays with their child during school vacation periods.

Calendar

The school calendar is available on the school website.

Canteen

The Canteen has a variety of healthy and nutritious sandwiches and hot food freshly made on the premises, a large selection of milks, drinks and fresh fruits. **Lunch orders can be placed and paid for online at www.flexischools.com.au.** This is a fast way to get your lunch. The canteen is open from 8.20am every morning to take orders and serve breakfast items.

Contact with students

As the school accepts responsibility for students while they are at school, parents/caregivers are asked to contact students only in an emergency **and only through the school office** in the Administration Block.

Contact with school staff

Contact and appointments with staff may be made by phone or by email. The school phone number and email address can be found on the first page of this booklet.

Diary

Student diaries will be distributed on the first day of school. Students need to bring this diary to every class each day. Students may also use an electronic calendar, such as the Google Calendar that is accessible through their Department of Education portal.

Financial Contributions

School Contributions

At Asquith Girls High School we strive to provide the very best learning environment for your child. Your continued financial support enables us to maintain our learning programs to the highest standard. Voluntary school contributions are requested to enhance the school's educational and sporting programs. These payments help provide additional educational resources for the benefit of students. Any enquiry in relation to school contributions must be referred to the Principal in writing.

Subject Contributions

Subject contributions are used to buy essential course materials that your child uses in class. At Asquith Girls High School, all parents/caregivers and students are made aware of costs associated with specific subjects prior to choosing to study that subject. The funds collected go directly to providing materials that are used and consumed in the education programs that each student has chosen to study.

Payment

Our preferred method of payment is via the link emailed to you by the school office. This method allows you to make a direct online payment using a credit or debit Visa or Mastercard. Alternatively, please go to www.asquithgir-h.schools.nsw.edu.au and click on the Make a Payment link.

Interviews

Appointments to speak with the Principal or a Deputy Principal are available through the school office. To organise an interview, please contact the school and provide the office staff with a range of times, and they will attempt to accommodate you in the shortest time frame possible.

Parents/caregivers may also seek interviews with the Head Teacher Wellbeing, Year Advisers, Careers Adviser or a Head Teacher by appointment through the office.

Learning Centre, Homework Hub & MEIOW

The school provides opportunities for students to receive additional support to complete homework and assessment tasks, receive assistance with areas of difficulty or be extended in their learning through a number of initiatives in the Library before and after school.

The Homework Hub runs every Monday, Wednesday and Friday morning from 8.00-8.30am. There is always a Learning and Support Teacher present to assist students, and students have access to Library resources including computer and internet access to enable them to complete tasks.

The Learning Centre operates on Monday and Wednesday afternoon from 3.15-4.15pm, and is staffed by a Learning and Support Teacher who is available to assist students as required.

Maths Enrichment and Improvement on Wednesday (MEIOW) occurs every Wednesday from 3.15-4.15pm. At this time, there are a number of Maths teachers present to provide students with specific support or extension in Maths.

Learning Support

Learning Support for students is available and based on classroom teacher referral. If you feel that your child may need learning support, contact your child's teacher in the subject area where they are having difficulty or speak to their Year Adviser.

Library

The Library is an excellent resource centre that is available to support student learning. The Library is normally open each morning before school at 8.15am, at lunchtime each day and after school on Monday and Wednesday until 4.15pm. Classes are frequently booked into the library by their teachers to work on research-based activities, giving students access to an up to date and constantly growing collection of resources. The library computers provide access to the catalogue of resources and to the broad range of software on the school's network and the internet. The Library also provides students with access to many fiction books to promote the value of reading for pleasure.



Lockers

Lockers are available for an annual fee. A secure padlock will be provided. Students will be granted the use of the locker for one year. More information about locker hire is available from the Administration Office.

Medication

Parents/caregivers are reminded that the Department of Education Policy prohibits the issuing of medication such as Panadol to students by school staff. Prescribed medication, such as asthma puffers, Epipens, antibiotics etc, should be carried by the student at all times and a Health Care Plan must be completed for the school. If you have any questions regarding your child's medication or you need to collect a Health Care Plan form, please contact the school office.

Money and personal property

Each student is responsible for looking after her own money which she should carry with her at all times. Money should **NOT** be left in school bags. Mobile phones, tablets (iPads) and other valuables are brought to school at the student's own risk. **All property must be fully labelled.**

Parents and Citizens' Association (P&C)

The P&C meets on the second Wednesday of each month in the Library at 7.30pm. The P&C work for the benefit of the school and its meetings enable parents/caregivers to keep in touch with school activities. Visiting speakers are invited to address the parents and there is a continuing policy to keep parents/caregivers informed on education practices and school initiatives ensuring common understanding and expectations.

School website

The school website has the link to the school newsletter, events on the school calendar, photo galleries, policies & procedures and information about the school.

<http://www.asquithgir-h.schools.nsw.edu.au/>

Sentral Parent Portal

Students and registered parents/caregivers can access student specific information such as timetables, reports and attendance data using the Sentral Parent Portal. Information outlining how to access the portal will be sent via email during the year.

Sickness

Students who become ill at school, or who suffer an injury, must report to the office staff. Upon assessment, students may be admitted to the sick bay. If students are too sick to return to class, parents/caregivers will be notified and asked to collect them from school. **Student mobile phones must not be used to bypass these procedures and students must not organise their parents to collect them – this is the responsibility of school staff.**

Study at home

No student can hope for reasonable success by only attending lessons. Some home study is essential to help understand the work taught in class. A suggestion for the minimum home study should be:

Year 7	5 hours/week
Year 8	6 hours/week
Year 9	8 - 10 hours/week
Year 10	8 - 10 hours/week
Years 11	12 - 15 hours/week
Years 12	15 - 20 hours/week

A Calendar and Study Timetable is a useful tool for all students to manage their study time wisely.

Never accept the statement that there is no homework. Apart from the work set by the teacher, there will always be:

- a) the lessons of the day to revise and learn
- b) earlier work to revise
- c) reading a library book or text book
- d) online modules on Google Classroom to complete

It is important for all students to cultivate good habits of reading

Supervision arrangements before school

In general, students other than Year 12 who have specific lessons should not arrive at school before 8.15am. The Principal and Deputy Principals are generally available in their offices after 8.15am. Students should refer any problems to them in their offices.



Technology Guidelines

Various forms of technology including digital devices, computers and laptops have been provided to improve learning experiences. Students are required to act respectfully and responsibly when using digital devices and to make good decisions with personal use of technology.

Bring Your Own Device (BYOD)

Under the BYOD Program, students are expected to bring their own computing device to school each day. This personal computing device needs to meet device specifications that are recommended by the school.

The device specifications identify the minimum system requirements/hardware specifications for student devices so that parents/caregivers are fully informed about Department of Education BYOD requirements. The school will provide separate documents that outline the details of the BYOD program and device specifications.

Acceptable usage of computing and communication devices

Computing and communication devices are to be used by students in accordance with all related policies established by the Department of Education (DoE), extracts of which are included in this document.

Access and security

- Students must not damage or disable computer, communication or network equipment provided by the Department of Education.
- School internet and online communication services should be used for genuine curriculum and educational activities and with the permission and supervision of a teacher. Users must not deliberately or carelessly waste or monopolise resources.
- Students are responsible for ensuring they have back-up copies of any digital work. Equipment failure will not be considered a valid excuse for the late submission of work.
- Students must not deliberately or inadvertently bypass virus protection, spam and security filtering, nor should they download unauthorised software, graphics or music
- Contact with peers, friends or family members unless authorised by a teacher is prohibited.
- Students must never send or publish:
 - o unlawful material or remarks including offensive, abusive, threatening, harassing, bullying or discriminatory comments.
 - o sexually explicit or suggestive material or correspondence.
 - o false or defamatory information about a person or organisation



Privacy and confidentiality

- Login information should not be shared or used by any other than the official user. Users should log off at the end of each session to avoid access to their accounts and data by others.
- Students must:
 - o not publish or disclose the email address or other personal information of any staff member of other student without that person's explicit permission
 - o not reveal personal information including names, addresses, photographs, credit card details of themselves or others
 - o ensure privacy and confidentiality is maintained by not disclosing or using any information in a way that is contrary to any individual's interests

Intellectual property and copyright

- The school retains ownership of any student information held by staff, both imprinted and in electronic forms
- Students will:
 - o not plagiarise information and will observe appropriate copyright clearance, including acknowledging the author or source of any information used
 - o ensure that permission is gained before electronically publishing users' work or drawings and always acknowledge the creator or author of any material published
 - o ensure any material published on the internet has the approval of the principal or their delegate and has appropriate copyright clearance

Misuse and breaches of acceptable usage

- Students will be held responsible for their actions while using computing and communication devices and any misuse may result in disciplinary action which includes, but is not limited to, the withdrawal of access to services.
- Students will be held responsible for any breaches caused by them allowing any other person to use their login information to any computing or communication service.

Monitoring, evaluation and reporting requirements

- Students must report:
 - o any internet site accessed that is considered inappropriate
 - o any suspected technical security breach involving users from other schools, TAFEs or from outside the NSW Department of Education.
- Students should be aware that their emails are archived and web browsing is logged. These records are official documents and may be used on investigations, court proceedings or for other legal purposes.

Tips for technology use

Passwords – keep your passwords SAFE! Do not share them with anyone!

Students have passwords for:

- The Asquith Girls High School network
- The DoE Student Portal – to access emails and set up your timetable, you also use this password to access the school internet (your teachers can help you if you can't log in)

Backing up your work

Back up your work in at least three ways:

- USB
- home computer and/or your home drive on the school computer
- email it to your DoE account
- cloud storage provided by the DoE, such as Google Drive or Microsoft OneDrive®

Remember, not completing work and failure to submit work on time due to technology is not acceptable.

Printing at school

Students are given a printing account which will provide printing of 100 black and white pages. This is the equivalent of \$10 of printing. Students can purchase additional printing credit at the school office in increments of \$10. Colour prints are also available.

Cybersafety

Students, teachers, parents/caregivers and members of the wider school community expect to feel safe at school, free from fear of bullying and harassment, intimidation and victimisation.

Remember you are **responsible** for:

- your actions when using technology
- someone else's actions if you give them your password to your e-learning account for the internet or access to your home drive on the school computers.

Ensure that you don't:

- take photographs or videos of anyone, unless directed to by a teacher and have permission
- record conversations or interviews with anyone, unless directed to by a teacher
- publish unacceptable or unlawful material or remarks
- make offensive, abusive, discriminatory or sexually suggestive comments.

Go to <http://www.esafety.gov.au/> for more information about staying safe online.

Transport

OPAL Card

The School Opal card gives eligible students free or discounted travel between home and school using the train and bus. To be eligible for a School Opal card, students may need to live 2.0km straight line distance or 2.9km walking distance from their school. If a student already has an Opal card and is changing schools, the Opal card needs to be updated for the new school. You can purchase a Child/Youth Opal card to travel after hours, on excursions, on weekends or during school holidays. All applications for new or replacement cards must be made online at [School Student Travel](#) on the Transport NSW website.

The attached [School Travel Advice](#) from CDC NSW provides further information.

2023 School Bus Timetable

MORNING BUSES

Route	Time	Bus Route
8010	07:32	FROM BEROWRA CHRISTIAN SCHOOL via Berowra Waters Rd (L) Barnettts (L) Easton (R) Wyanna (R) Barnettts (L) Turner (R) Elizabeth (R) Woodcourt , Hillcrest (L) Berowra Waters (L) Gully Please Note: Bus does not pick up Asquith Girls HS students between Crowley and Pacific Highway return Gully then (L) Highway to Berowra Station, then via Highway to drop students at Asquith Station, Highway off Ramp
8030	07:50	FROM CROWLEY RD AFTER BEROWRA WATERS RD via Crowley (L) Waratah (R) Anembo (R) Yallambee, Gwandalan (R) Kywong (R) Redwood (L) Bambil (R) Yallambee (R) Highway drop students at Asquith Station, Highway off Ramp
596	08:00	FROM MCKAY AND MONTVIEW via (L) Galston to Evans, transfer to bus 8014
8014	08:00	FROM HORNSBY HEIGHTS (BLACK ASH PL) all stops via Somerville (L) Galston (L) Peats Ferry, Highway (R) Asquith Bridge (L) Royston (R) Dudley (R) Chelmsford (R) Baldwin to Asquith Girls High
8098	08:02	FROM OXLEY DR (MOUNT COLAH) via Route 595 via Arthurs Circle, Mt Colah Station (08:22), then via Highway (L) Asquith Bridge (L) Royston (R) Dudley to Asquith Girls High

AFTERNOON BUSES

Route	Time	Bus Route
9033 Tue only	14:40	TO HORNSBY HEIGHTS (picks up in Baldwin Ave) via Railway Bridge (L) Highway, Peats Ferry (R) Galston (R) Montview to McKay, return Montview (L) Galston (L) Somerville to Black Ash
9090 Tue only	14:40	TO MOUNT COLAH (picks up in Baldwin Ave) via Railway Bridge (R) Highway (L) Beryl (R) Red Cedar (L) Foxglove (R) Lancelot (R) Excelsior (R) Highway
9033 Mon, Wed-Fri	15:20	TO HORNSBY HEIGHTS (picks up in Baldwin Ave) via Railway Bridge (L) Highway, Peats Ferry (R) Galston (R) Montview to McKay, return Montview (L) Galston (L) Somerville to Black Ash
9072 Mon, Wed-Fri	15:20	TO BEROWRA HEIGHTS (picks up in Baldwin Ave) via Railway Bridge (R) Highway (L) Beryl (R) Red Cedar (L) Foxglove (R) Lancelot (R) Excelsior (L) Highway (L) Yallambee, Gwandalan (R) Kywong (R) Redwood (L) Bambil (L) Yallambee (R) Anembo (L) Waratah (R) Crowley (R) Berowra Waters (L) Highway, Berowra Station (15:52) transfer to Route 599 for Berowra Heights

Bell Times

Monday		Tuesday		Wednesday & Thursday		Friday	
Period	Start Time	Period	Start Time	Period	Start Time	Period	Start Time
1	8:40	1	8:40	1	8:40	1	8:40
Recess	9:48	Assembly	9:40	2	9:48	2	9:43
2	10:08	Recess	10:22	Recess	10:51	Recess	10:46
3	11:11	2	10:42	3	11:11	3	11:11
Lunch 1	12:14	3	11:42	4	12:14	4	12:14
Lunch 2	12:34						
4	12:54	Lunch 1	12:42	Lunch 1	1:17	Lunch 1	1:17
		Lunch 2	1:02	Lunch 2	1:37	Lunch 2	1:37
5	1:57	4	1:22	5	1:57	5	1:57
END OF DAY	3:00	END OF DAY	2:22	END OF DAY	3:00	END OF DAY	3:00

School Map

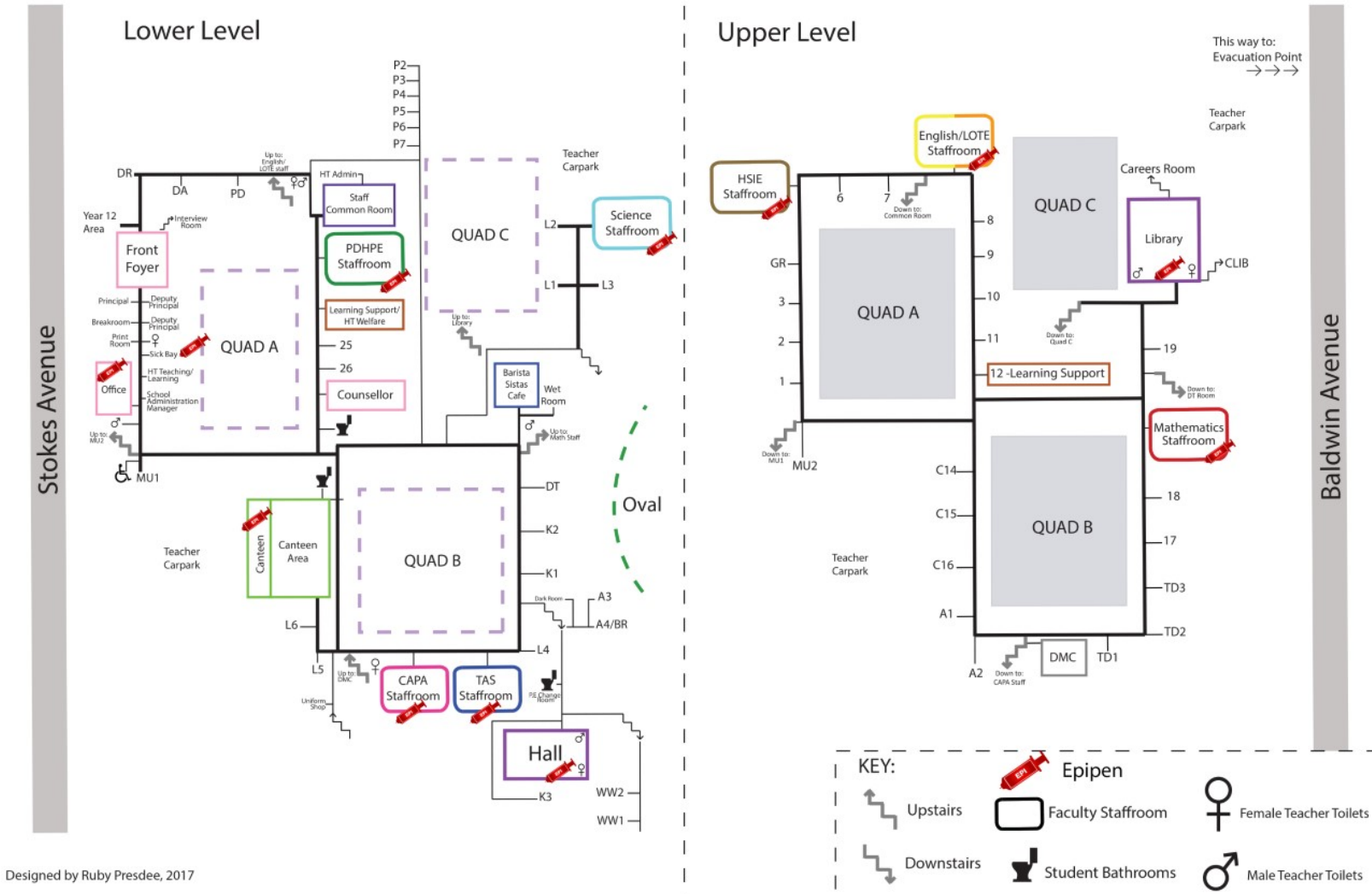



SCHOOL UNIFORM REQUIREMENTS

SUPPLIED BY:

SCHOOL LOCKER[®]



JUNIOR UNIFORM



PE UNIFORM



SENIOR UNIFORM



JUNIOR UNIFORM YEARS 7-10

- AGHS check skirt
- Green tailored pants or shorts
- AGHS white blouse with green trim collar
- AGHS green V-neck fleece jumper
- Mint green V-neck jumper
- AGHS black soft shell jacket
- Black scarf (optional)
- Black enclosed lace up leather school shoes as per the department's Health & Safety Directorates footwear guidelines
- Plain white ankle length socks or black stockings

SENIOR UNIFORM YEARS 11 & 12

- AGHS mint green pleated skirt
- Green tailored pants or shorts
- AGHS white blouse with green trim collar
- AGHS green V-neck fleece jumper
- Mint green V-neck jumper
- AGHS black soft shell jacket
- Black scarf (optional)
- Black enclosed lace up leather school shoes as per the department's Health & Safety Directorates footwear guidelines
- Plain white ankle length socks or black stockings

SPORTS UNIFORM YEARS 7-12

- AGHS white polo shirt with green collar
- AGHS green sports shorts
- AGHS green microfibre track pants and jacket
- Sports shoes with white ankle length socks

Please note:

Sports uniform must only be worn during PE classes, not to and from school, except in the following circumstances:

- Years 8, 9 & 10 have sport on Mondays and may wear sports uniform all day on Monday
- Special sports days such as swimming and athletics carnivals, cross country and games days.

FOOTWEAR GUIDELINES FOR NSW GOVERNMENT SCHOOLS

Footwear is an important safety item. Good soles provide a sound grip on the floor preventing accidents such as slips, trips and falls from occurring. Footwear can also protect feet from damage caused by accidents such as falling objects or chemical spillages. These guidelines have been developed to assist NSW government schools in providing a safe working and learning environment.

Students at AGHS participate in a range of subjects where black enclosed lace up leather school shoes are required, including: industrial arts, science, food technology.

PURCHASING THE UNIFORM

Purchase either online or at the onsite uniform shop.

The onsite shop is located off Quad B at the school hall end and is **open during term time on Wednesdays from 8:00-11:00am**. Opening hours will increase during seasonal change over periods from Term 1 to Term 2, in the lead up to the academic year during the school holidays and at the beginning of the academic year.

Students and parents/caregivers can purchase directly from the store or students can try on uniforms before purchasing either in store or online.

Good quality second hand uniforms are also available from the onsite store.

The School Locker: service@theschoollocker.com.au OR 0455622634



If there are any concerns with obtaining the required school uniform, please contact the school on 9477 6411 or asquithgir-h.school@det.nsw.edu.au

Available online: theschoollocker.com.au/schools/asquith-girls-high-school/uniforms

Asquith Girls High School

Developing high achieving young women who are responsible and independent leaders and learners.

Hat Policy

The wearing of a cap is recommended for all outdoor PE and sport lessons. Free sunscreen is available to staff and students at any time throughout the school day from the PDHPE staff room and during outdoor lessons.

Protective Clothing

Technology & Applied Studies (TAS): in all Food Technology classes students are required to wear a white apron and cap. These are available from the school clothing pool. Students will need these items for the Food component of Technology Mandatory, which will be studied in Year 8. Students must also wear enclosed black, leather lace up shoes for safety in all technology rooms.

Visual Arts: Students are required to wear protective covering of clothes, eg: old shirt or apron.



Science: Students are required to wear enclosed black, leather lace up shoes in science labs for safety. Protective equipment, including safety glasses, is also required during experiments.

ALL CLOTHING SHOULD BE CLEARLY LABELLED

Purchasing the uniform

The school's uniform supplier is School Locker and uniforms can be purchased either online or at the onsite uniform shop.

The onsite shop is located off Quad B at the school hall end and is open during term time on Wednesdays from 8:00-11:00am. Opening hours will increase during seasonal change over periods from Term 1 to Term 2, in the lead up to the academic year during the school holidays and at the beginning of the academic year.

Students and parents/caregivers can purchase directly from the store or students can try on uniforms before purchasing either in store or online.

Good quality second hand uniforms are also available from the onsite store.

Contact: School Locker: service@theschoollocker.com.au OR 0455 622 634



The School Song

We'll sing the song of Asquith
With pride and unity
With our heads held high we'll stand as one
As women of society
We'll remember the opportunities
And the knowledge that we've gained
With a strong sense of community
School spirit is maintained
Surrounded by such beauty
It's a creative place to be
We'll look towards the future
Inspiring us all to succeed
With friendships that we value
We'll look back on these formative years
And we'll sing to the song of our school.

